



Offshore

Sea Master



Ship's History

Former Norwegian Coastguard vessel, built in 1988. Designed for troop transport and coastguard service.

Current use

The military interior has been significantly modernised so that the ship is now fully equipped for her new role. The size of the Sea Master, is such, that she makes an ideal work platform for expedition and surveying tasks.

On board there is ample space for customer needs such as, as a mobile laboratory, an office, a data interpretation centre, a meeting place or use as a Multibeam Scanning vessel.

The Sea Master's operational range is large as the vessel can carry

fuel and water for a considerable period at sea. This allows a more flexible and efficient time scale for studies of the sea bed and the environment enabling the scientific staff to work within tight schedules, possibly, due to meteorological conditions which might otherwise curtail operations.

Accommodation is in six comfortable double cabins, wireless internet is available throughout the vessel and off duty entertainment is provided by a modern DVD library and a flat screen TV. The Sea Master is fully manned with a modern galley providing hot freshly cooked food. Special dietary needs may be provided for upon request.

See movie here:

<https://www.youtube.com/watch?v=Ik4fUa6T5fU>



Offshore

MAIN

Design:	Eikefjord Marine A/S
Flag:	DANSK
Built:	1988 Eikefjord
Marine A/S Eikefjord	
Class:	RINA Services AUT-CCS
Passengers:	12 pax
Crew:	2/4- 12/24 hours
Range :	1200 nm (150 nm from shore)
Hull construction :	GPR
Superstructure construction:	GPR
Length o.a. :	34,00 m (excl bow fender)
Beam:	7,30 m
Max draught:	1,80 m
BRT:	192 t
Speed:	Service 16-18max 22 knots
Bunker capacity:	17000 liters
Fresh water capacity:	4000 liters
Ballast water:	4000 liters
Black water:	1400 liters
Lub oli:	1 x 1000 liters
Sloop oli:	1 x 500 liters
Deadweigh light ship:	90t
Total forward deck capacity:	5 T
Forward deck dimensions:	ca. 50 m2
Total aft deck capacity:	3,5 T
Aft deck dimensions:	6 x5 meter
IMO number:	4603408
Engines rating:	2 x 840 kw a 1800 rpm
Engine:	2 x Deutz MWM V8
Propulsion:	2 x Servo gear Pitch
Gear box:	2 x ZF gear BU 255
Generators:	2 x John Deer 404STFM 50 HK/KW 77/56

Bow Thruster: 1 x 40 kW

CARGO HANDLING

Max cargo capacity on deck: 12t	
Deck strength:	2 t/m ²
Crane:	1 x 900 XL 3 tm
Max lifting capacity at max outreach:	SWL 1000 kg / 7,9 mtr in winch
Max lifting capacity:	3000 kg
A Frame:	SWL 800 kg
Anchor Winch:	1 X SHHP-TW

NAVIGATION AND COMMUNICATION

Radar:	2 X Furuno 20"
Electronic chart:	Sodena
Compass:	J-G Krohn & Søn AS
Satellite Compass:	1 X Furuno GP32
GPS:	Furuno
AIS:	Furuno AIS FA-100
Wind Speed	Simrad IS 15
Autopilot:	Simrad
MF/DSC:	Furuno DSC - 60
VHF/DSC:	Sailor VHF DSC-A
MF:	Furuno FS 1562-15
Navtex:	Furuno NX - 500
VHF:	Sailor RT 2048/RT4822
Crew finder:	RT-202 Rhotheta
Ekkolod:	Furuno FCV 582 L
Log:	Furuno Doppler
Satellit Internet:	KNS 85 cm

PASSENGER FACILITIES

4 Comfortable cabins with 8 beds
Comfortable passenger lounge with TV lounge with sofa lounges and flat screens
Gallery, Toilet/Shower and change room

CREW FACILITIES

4 Comfortable cabins with TV and with Toilet/Shower



Offshore

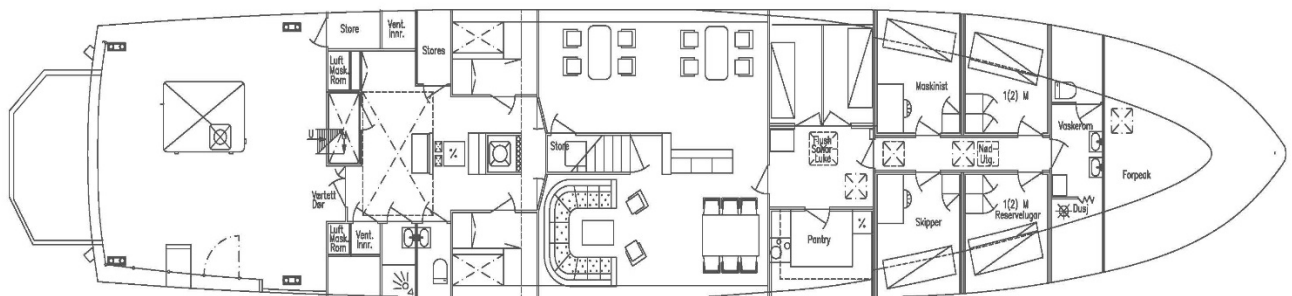

1 DEKK